

Quick start guide KF3A-2219-EU-GFOB

Emergency Person to Person Key Fob with Shock Detection



Any questions? Call us on +353 (0)1 247 9007

Standard Activation

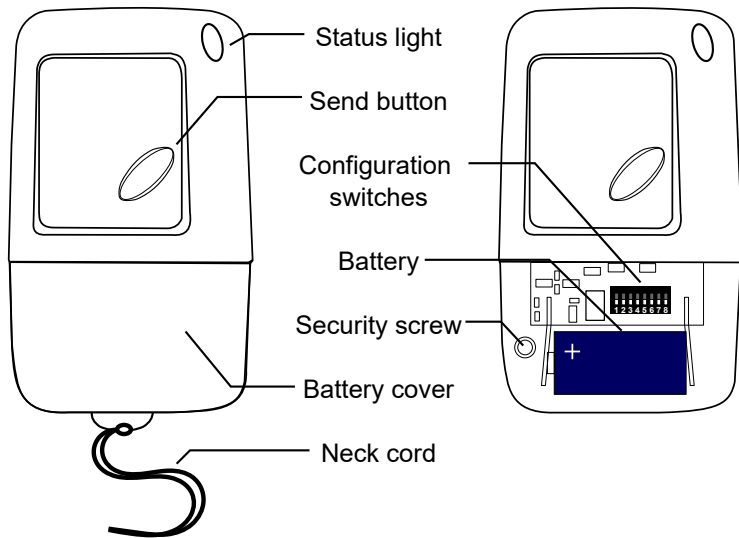

1. A battery is already installed in the Keyfob.

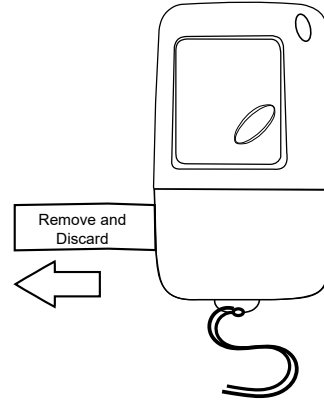

To activate the unit simply remove the paper tab by pulling it gently away from the unit.

The keyfob is now ready to go and is set to illuminate person to person by default.

2. Sending a signal

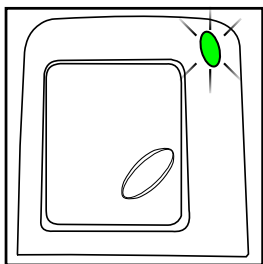

The supplied lithium battery should provide a large number of activations

Press the send button. The status light will shine green and the Pager or SignWave should receive a person to person signal.

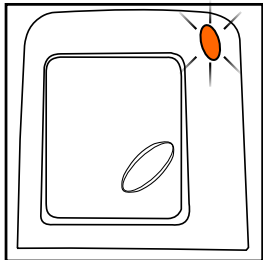

If the light shines orange when the button is pressed the internal battery is low and should be replaced (see step 3).

3. Low battery

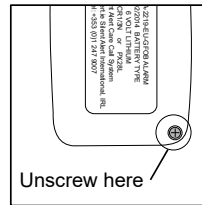

When the battery needs replacing remove the screw from the rear of the unit.

Turn the unit over and gently push the battery cover upwards exposing the battery and configuration switches.

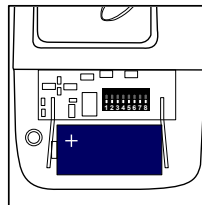

Replace with a 6V lithium battery (2CR1/3N OR PX28L)

Shock Detection Activation

The KF3A-2219-EU-GFOB variant incorporates a sensor which will trigger the unit automatically when the device receives a shock.

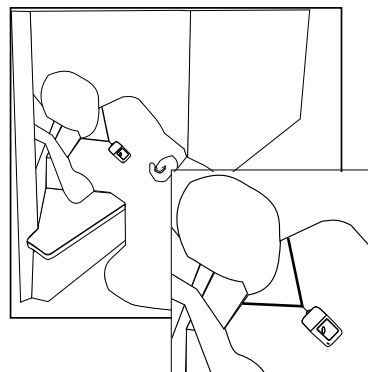
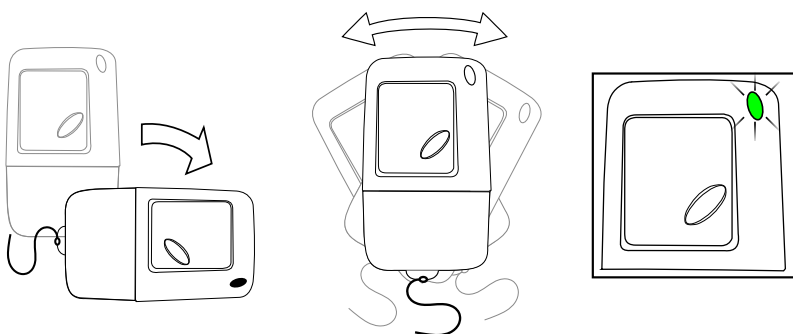

For best results we recommend the using the neck cord provided to allow the keyfob to hang around the neck. Placing the keyfob in a pocket may reduce the effectiveness of the shock sensor.

Advanced settings KF3A-2219-EU-GFOB

Emergency Person to Person Key Fob with Shock Detection



Any questions? Call us on +353 (0)1 247 9007

Changing the system channel code

NOTE. In most cases it is not necessary to change the system code. However, when one or more systems are in close proximity, system codes can be used to avoid interference from other SA3000 systems using up to a maximum of 16 channels.

The monitor is supplied with no system code switches set (system code 1). For reference this is the factory setting should you need to re-set the unit.

System codes can be set using key switches 1 - 4.

The diagram to the right shows the 16 possible combinations.

Be sure that the same system code is set on the receiver to be used and any other monitoring options in that system.

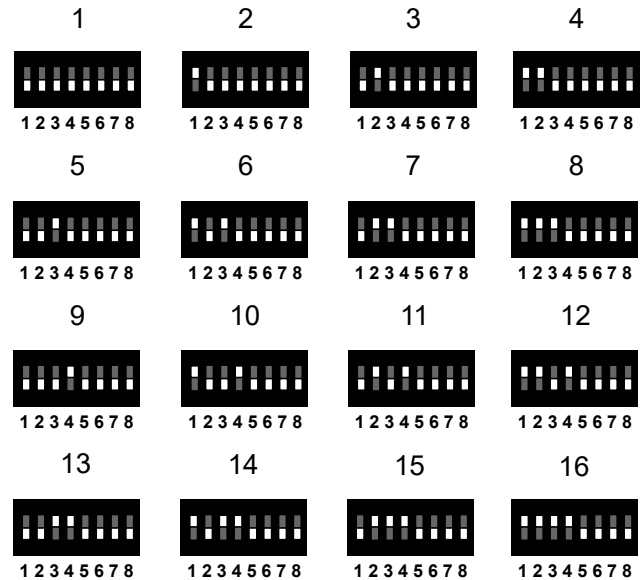

WARNING! PRODUCT CONTAINS A LITHIUM BATTERY.

Battery can explode or leak if heated, disassembled, shorted, recharged, exposed to fire or high temperature or inserted incorrectly. Keep in original package until ready to use. Do not carry batteries loose in your pocket or purse.

Keep batteries away from children. If swallowed, consult a physician at once.

Under certain misuse conditions and by abusively opening the battery, exposed lithium can react with water or moisture in the air causing potential thermal burns or fire.